

# No-Heat Premium Tool Tape

## For Web Tool Attachments

### User Instruction Manual

**⚠ PLEASE READ - IMPORTANT SAFETY INFORMATION**

Please read and understand the manufacturer's instructions for each component or part of the complete system. Manufacturer's instructions must be followed for proper use, care, and maintenance of this product. These instructions must be retained and be kept available for the worker's reference at all times. Alterations or misuse of this product or failure to follow instructions, may result in serious injury or death.

**⚠ WARNINGS AND LIMITATIONS**

- Never use the FallTech For Tools™ components for personal fall arrest, restraint, or work positioning.
- Inspect the FallTech For Tools™ components before each use in accordance with the requirements in Section 6 below.
- Never modify or alter the FallTech For Tools™ components. This includes extending the length or tying knots in the tool tethers.
- Never attach any tool or equipment to yourself that weighs more than 5 lbs (2.3 kg).
- Never use this products to tether a knife, sharp blade, or other sharp tool.
- Immediately inspect the FallTech For Tools™ components for damage if the tool has experienced a drop.
- Do not use this product on tools or equipment that exceed the rated capacity of the lowest rated component in the FallTech For Tools™ system.
- Do not use this product if it will interfere with any personal fall protection equipment or the operation of the connected tools or equipment.
- Avoid using around moving machinery, thermal, electrical and/or chemical hazards as contact may cause serious injury or death.
- Ensure there is adequate tool drop clearance. The tool fall/swing path must not endanger you or any other workers.
- All procedures shown in these instructions are for FallTech For Tools™ products only.
- Report all incidents of dropped tools to your supervisor or safety coordinator.
- Do not use this product in temperatures below -31 degrees F (-35 degrees C) or above 113 degrees F (45 degrees C)

**1.0 Description** - The FallTech For Tools™ No-Heat Premium Tool Tape is a self-fusing silicone tape used to attach the FallTech For Tools™ D-Ring Attachment points on tools up to 5 lbs., for use with FallTech® Tool Tethers, Wrist Attachments, and Tool Anchors.

**2.0 Application** - The FallTech For Tools™ No-Heat Premium Tool Tape is designed to be used as a component in a dropped object prevention program. The tool tethering system is an assembly of components and subsystems to arrest a tool from an accidental drop. The system typically consists of tool attachment, a tool tether, and a tool anchor. See product labels for maximum load capacity and maximum allowable tether length.

**3.0 System Requirements** - The FallTech For Tools™ No-Heat Premium Tool Tape is designed for use by a single tool with a combined weight no greater than 2 lbs (0.9kg) or 5 lbs (2.3 kg), based on the rating of the D-ring attachment. **DO NOT** use the tape on tapered tools or on tools that have rough or sharp edges.

**3.1 Compatibility of Components:** Equipment is designed for use with approved components and subsystems only. Substitutions or replacements made with non-approved components or subsystems may jeopardize compatibility of equipment and may affect the safety and reliability of the complete system.

**3.2 Making Connections:** Only use locking connectors with this equipment. Only use connectors that are suitable to each application. Ensure all connections are compatible in size, shape, and strength. Do not use equipment that is not compatible. Visually ensure all connectors are fully closed and locked.

**4.0 Installation**

**4.1 Pre-Use Inspection:** Inspect the D-Ring Attachments thoroughly before attaching it to the to the tool for damage or wear. Inspect the webbing and stitching for cuts, fraying, and signs of damage to the webbing from excessive wear or abrasion. If any of these conditions exist, remove from service.

**4.2 Installation Procedure:** Ensure the tool and D-Ring Attachment is clean and free of oil, grease, or debris, which could prevent adequate bonding of the tape onto the tool. The D-Ring Attachment should be placed away from the functional parts of the tool and the D-Ring should face away from the center of gravity. See the figures below for the installation steps.

**Step 1**

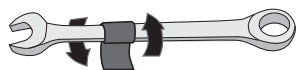

Wrap one revolution of tape around the tool, gradually removing the plastic liner and maintaining the tension of the tape as it is wrapped.

**Step 2**

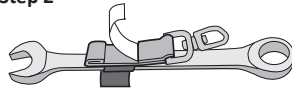

Place the D-Ring Attachment onto the tape, ensure the rolled edge is facing upward.

**Step 3**

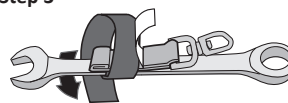

Fold the product label back, wrap the D-Ring Attachment onto the tool with 8 wraps of tape for a 2 lb. tool and 12 wraps for a 5 lb. tool. Maintain tension and wrap with a 50% or greater overlap. Do not tape over the rolled edge.

**Step 4**

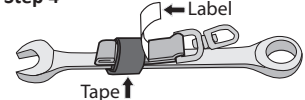

After the taped connection is complete, cut the end of the tape, apply tension once again and adhere it to the tape. Test the connection to ensure a secure installation.

**5.0 Maintenance, Service, and Storage**

**5.1 Maintenance:** No scheduled maintenance is required, other than the replacement of items that fail inspection.

**5.2 Service:** There are no specific service requirements for this system component.

**5.3 Storage:** Store in a clean, dry, chemical-free environment out of direct sunlight. Avoid prolonged exposure to extreme heat conditions.

**6.0 Inspection** - Inspect the FallTech For Tools™ No-Heat Premium Tool Tape for damage, wear, and the adhesive quality. If any abnormalities are found, remove from service.

**6.1 Tape Shelf Life:** 1 year from the date of manufacture

FallTech For Tools™ No-Heat Premium Tool Tape Specifications				
Model #	Description	Capacity and Standards	Tape Image	Compatible Tool Attachments
5307B1 5307B10	12' No-heat Premium Tool Tape for Web Attachment Points 12' No-heat Premium Tool Tape for Web Attachment Points, Pack of 10	Up to 5 lbs. (2.3 kg)  ANSI/ISEA 121-2018		5101A10 5306A10 5102A10 5302A10

This manual is intended to meet the Manufacturer's Instructions as required by the American National Standards Institute (ANSI), International Safety Equipment Association (ISEA) and should be used as part of an employee training program as required by the Occupational Safety and Health Administration (OSHA).