

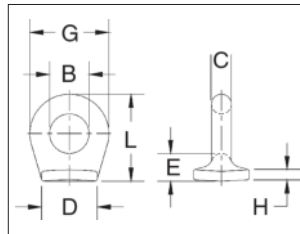

S-264



- Forged steel - Quenched & Tempered.
- Forged from 1035 carbon steel.
- Excellent welding qualities.
- Widely used on farm machinery, trucks, steel hulled marine vessels and material handling equipment.
- Reference American Welding Society specifications for proper welding procedures.



S-264 Pad Eyes

| Size No. | Stock No. | Weight Per 100 (lb) | Dimensions (in) | | | | | | |
|----------|-----------|---------------------|-----------------|-----|------|-----|------|-----|------|
| | | | B | C | D | E | G | H | L |
| * 0 | 1090722 | 2.80 | .25 | .19 | .63 | .31 | .63 | .09 | .75 |
| * 1 | 1090740 | 6.50 | .38 | .25 | .88 | .41 | .88 | .13 | 1.03 |
| * 1-1/2 | 1090768 | 10.40 | .63 | .25 | 1.00 | .44 | 1.13 | .16 | 1.31 |
| 2 | 1090786 | 21.10 | .75 | .38 | 1.06 | .50 | 1.50 | .19 | 1.63 |
| 4 | 1090802 | 52.20 | 1.00 | .56 | 1.44 | .78 | 2.13 | .22 | 2.34 |
| 5 | 1090820 | 82.50 | 1.25 | .69 | 1.75 | .81 | 2.63 | .25 | 2.75 |

*Meets the requirements of Military Specification MS-51930A.